

105 WEST MAIN ST AND LAWSON PROPERTIES PRELIMINARY PLAT

NEW MARKET ELECTION DISTRICT NO. 9
TAX I.D. 09-264361 & 09-257004
TOWN OF NEW MARKET, FREDERICK COUNTY, MARYLAND

JULY, 2020

| SHEET INDEX | |
|-------------|-------------------------------------|
| SHEET # | TITLE |
| 1 | Cover Sheet |
| 2 | Site Layout Plan |
| 3 | Grading, Paving And Stormdrain Plan |
| 4 | Utility Plan |
| 5 | Road Sections Plan |
| 6 | Landscape And Lighting Plan |
| 7 | NRI / FSD |
| 8 | PFCP |

| OVERALL SITE AREA SUMMARY | |
|--|------------------|
| AREA IN RESIDENTIAL LOTS | 0.9960 Ac |
| AREA IN NON-RESIDENTIAL LOTS | 0.8567 Ac |
| AREA IN PUBLIC R.O.W. & ACCESS DRIVE & PARKING | 0.4890 Ac |
| AREA IN OPEN SPACE/SWM | 0.3995 Ac |
| TOTAL SITE PLAN AREA | 2.7412 Ac |

FIRE AND RESCUE NOTES

- FIRE DEPARTMENT ACCESS ROADS SHALL BE ACCESSIBLE DURING ALL TYPES OF WEATHER AND AT ALL TIMES.
- FIRE DEPARTMENT ACCESS ROADS SHALL BE CAPABLE OF SUPPORTING FIRE APPARATUS AT ALL TIMES AND BE A MINIMUM OF 20 FEET WIDE.
- FIRE DEPARTMENT ACCESS SHALL BE PROVIDED AND MAINTAINED TO ALL STRUCTURES UNDERGOING.

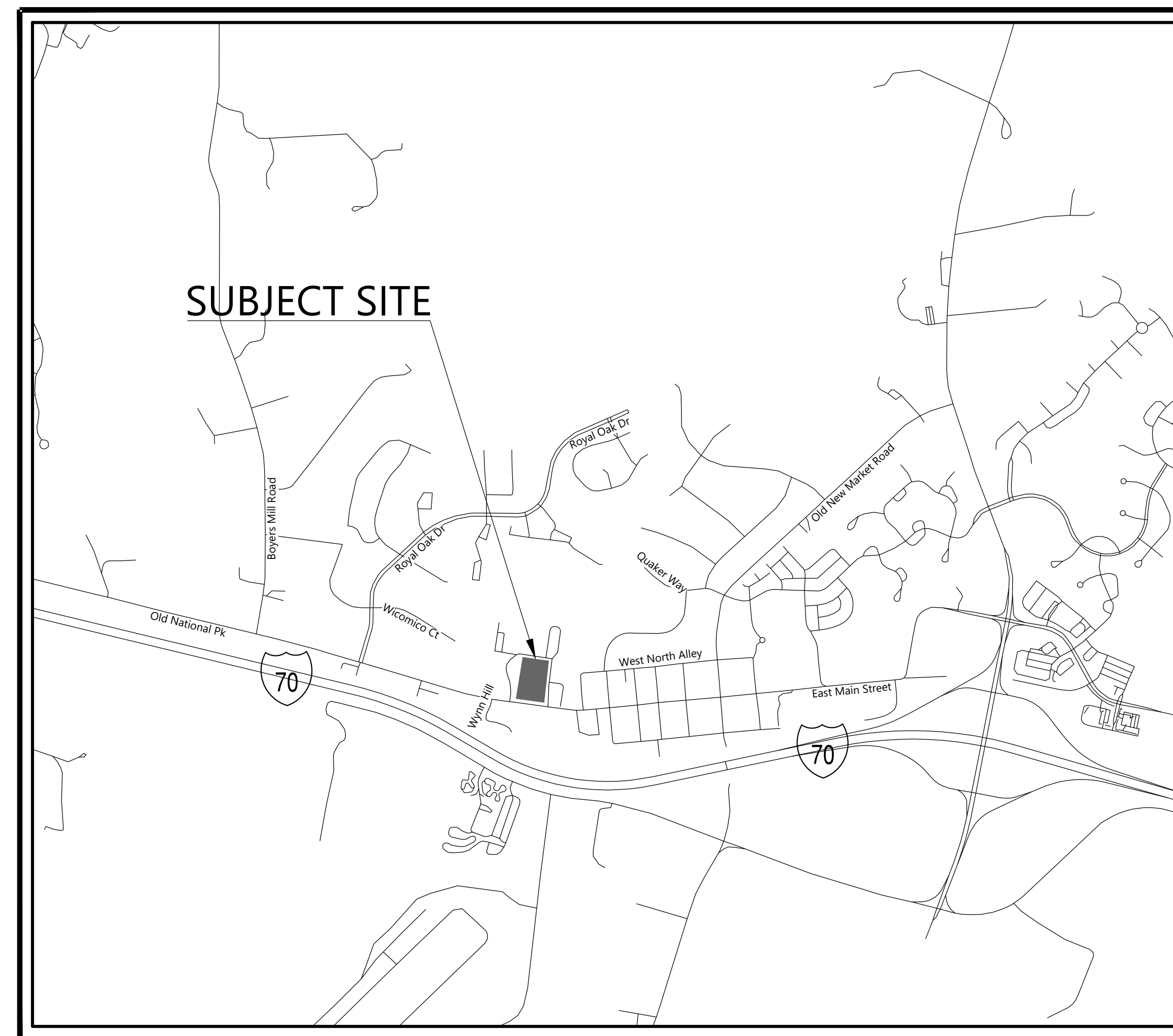

VICINITY MAP

SCALE: 1" = 1000'

LEGEND

| | EXISTING | PROPOSED |
|----------------------------------|----------|----------|
| INTERIOR LOT LINE | --- | --- |
| R/W-PROPERTY LINE | --- | --- |
| CENTERLINE | --- | --- |
| EASEMENTS | --- | --- |
| CURB & GUTTER | --- | --- |
| BUILDINGS | [Symbol] | [Symbol] |
| SPOT ELEVATIONS | +303.66 | +30.45 |
| BENCH MARK | [Symbol] | [Symbol] |
| CONTOURS | [Symbol] | [Symbol] |
| STORM DRAIN | [Symbol] | [Symbol] |
| SANITARY SEWER | SS | SS |
| WATER LINES | EX. W | W |
| U/G GAS, ELEC. OR TELEPHONE | G.E.T. | G.E.T. |
| OVERHEAD ELEC. LINES | O.H.E. | O.H.E. |
| DRAINAGE FLOW & DIRECTION | [Symbol] | [Symbol] |
| MANHOLE | [Symbol] | [Symbol] |
| INLETS | [Symbol] | [Symbol] |
| PLUG OR CAP | [Symbol] | [Symbol] |
| WATER VALVE | [Symbol] | [Symbol] |
| FIRE HYDRANT | [Symbol] | [Symbol] |
| UTILITY POLE | [Symbol] | [Symbol] |
| LIGHT POLE | [Symbol] | [Symbol] |
| SANITARY SEWER LATERALS | [Symbol] | [Symbol] |
| WATER LATERALS | [Symbol] | [Symbol] |
| REDUCER | [Symbol] | [Symbol] |
| FENCE | [Symbol] | [Symbol] |
| CONCRETE | [Symbol] | [Symbol] |
| LIMIT OF DISTURBANCE | LOD | LOD |
| SILT FENCE | [Symbol] | [Symbol] |
| SUPER SILT FENCE | [Symbol] | [Symbol] |
| EARTH DIKE | [Symbol] | [Symbol] |
| STABILIZED CONSTRUCTION ENTRANCE | [Symbol] | [Symbol] |
| INLET PROTECTION | [Symbol] | [Symbol] |
| ROCK OUTLET PROTECTION | [Symbol] | [Symbol] |
| TRAFFIC SIGN | [Symbol] | [Symbol] |
| TRAFFIC BARRIER (GUARDRAIL) | [Symbol] | [Symbol] |
| CONCRETE PAVERS | [Symbol] | [Symbol] |
| HANDICAP RAMP | [Symbol] | [Symbol] |
| HANDICAP PARKING & ACCESS AISLE | [Symbol] | [Symbol] |

DESIGN CERTIFICATION

I HEREBY CERTIFY THAT THIS PLAN HAS BEEN DESIGNED IN ACCORDANCE WITH LOCAL ORDINANCES, COMAR 26-17-01-07 AND "2011 MARYLAND STANDARDS AND SPECIFICATIONS FOR SOIL AND EROSION AND SEDIMENT CONTROL" (LATEST VERSION AND REVISIONS)

ENGINEER'S NAME _____ LICENSE REG. NO. _____ DATE _____

PROFESSIONAL CERTIFICATION

I HEREBY CERTIFY THAT THESE DOCUMENTS WERE PREPARED OR APPROVED BY ME, AND THAT I AM A DULY LICENSED PROFESSIONAL LANDSCAPE ARCHITECT UNDER THE LAWS OF THE STATE OF MD

NAME _____ DATE _____
LICENSE REG. NO. _____ EXPIRATION DATE _____

APPROVED BY THE TOWN OF NEW MARKET

BY: _____ DATE _____

Z:\Shared\0070-00-00 - 105113 W Main\CAD\Preliminary Plan\Sht 001 - COVER.dwg (COVER)

| REVISION | DATE | REVISION | DATE |
|----------|------|----------|------|
| | | | |
| | | | |
| | | | |
| | | | |

OWNER/DEVELOPER
WEST MAIN STREET PROPERTIES
JABEZ PROPERTIES LLC

2941 GREEN VALLEY ROAD
IJAMSVILLE, MD 21754
XXX-XXX-XXXX
TONY CHMELIK

COVER SHEET
PRELIMINARY PLAN



47 E South Street, Suite 302 | Frederick, MD 21701 | Office: 240-578-4010 | cdm-consulting.com

| | BY | DATE |
|-------------|--------------------------|----------|
| BASE DATA | | 12/11/18 |
| DESIGNED | DC/BM | 03/30/20 |
| DRAWN | WK/VM | 03/30/20 |
| REVIEWED | RM | 03/30/20 |
| CONTACT: | | |
| RELEASE FOR | <input type="checkbox"/> | |
| BY: _____ | DATE _____ | |

105 WEST MAIN ST & LAWSON

TAX I.D. 09-264361 & 09-257004
TOWN OF NEW MARKET
FREDERICK COUNTY, MD

| |
|--------------------|
| SCALE: N.T.S. |
| JOB No. 0070-00-00 |
| DATE: 07/14/20 |
| SHEET No. 1 of 8 |