

105 WEST MAIN ST AND LAWSON PROPERTIES

DEVELOPMENT STORMWATER MANAGEMENT

FREDERICK COUNTY WATER AND SEWER CONTRACT NO. #####

NEW MARKET ELECTION DISTRICT NO. 9
TAX I.D. 09-248161
TOWN OF NEW MARKET, FREDERICK COUNTY, MARYLAND

LEGEND

	EXISTING	PROPOSED
INTERIOR LOT LINE	---	---
R/W-PROPERTY LINE	---	---
CENTERLINE	---	---
EASEMENTS	---	---
CURB & GUTTER	---	---
BUILDINGS	---	---
SPOT ELEVATIONS	+303.68	+304.45
BENCH MARK	BM	BM
CONTOURS	450 450 450	310
STORM DRAIN	SS	SS
SANITARY SEWER	SS	SS
WATER LINES	EX. W	W
U/G GAS, ELEC. OR TELEPHONE	G.E.T.	G.E.T.
OVERHEAD ELEC. LINES	O.H.E.	O.H.E.
DRAINAGE FLOW & DIRECTION	→	→
MANHOLE	MANHOLE	MANHOLE
INLETS	INLET	INLET
PLUG OR CAP	PLUG	PLUG
WATER VALVE	WV	WV
FIRE HYDRANT	FH	FH
UTILITY POLE	UP	UP
LIGHT POLE	LP	LP
SANITARY SEWER LATERALS	SS-L	SS-L
WATER LATERALS	W-L	W-L
REDUCER	R	R
FENCE	F	F
CONCRETE	C	C
LIMIT OF DISTURBANCE	LOD	LOD
SILT FENCE	SF	SF
SUPER SILT FENCE	SSF	SSF
EARTH DIKE	ED	ED
STABILIZED CONSTRUCTION ENTRANCE	SCE	SCE
INLET PROTECTION	IP	IP
ROCK OUTLET PROTECTION	ROP	ROP
TRAFFIC SIGN	TS	TS
TRAFFIC BARRIER (GUARDRAIL)	TB	TB
CONCRETE PAVERS	CP	CP
HANDICAP RAMP	HR	HR
HANDICAP PARKING & ACCESS AISLE	HP	HP

SHEET NO.	TITLE	ID
01	COVER SHEET	CS-1
02	EXISTING DRAINAGE AREA MAP	EC-1
03	PROPOSED ESD DRAINAGE AREA MAP	PC-1
04	IMPERVIOUS AREA MAP	IM-1
05	STORMWATER MANAGEMENT PLAN	SW-1
06	STORMWATER MANAGEMENT NOTES & DETAILS	SW-2

AREA	SF	AC
AREA IN RESIDENTIAL LOTS	43,384 SF	0.9960 AC
AREA IN NON-RESIDENTIAL LOTS	37,318 SF	0.8567 AC
AREA IN PUBLIC R.O.W. & ACCESS DRIVE & PARKING	21,303 SF	0.4890 AC
AREA IN OPEN SPACE/SWM	17,404 SF	0.3995 AC
TOTAL SITE PLAN AREA	119,408 SF	2.7412 AC

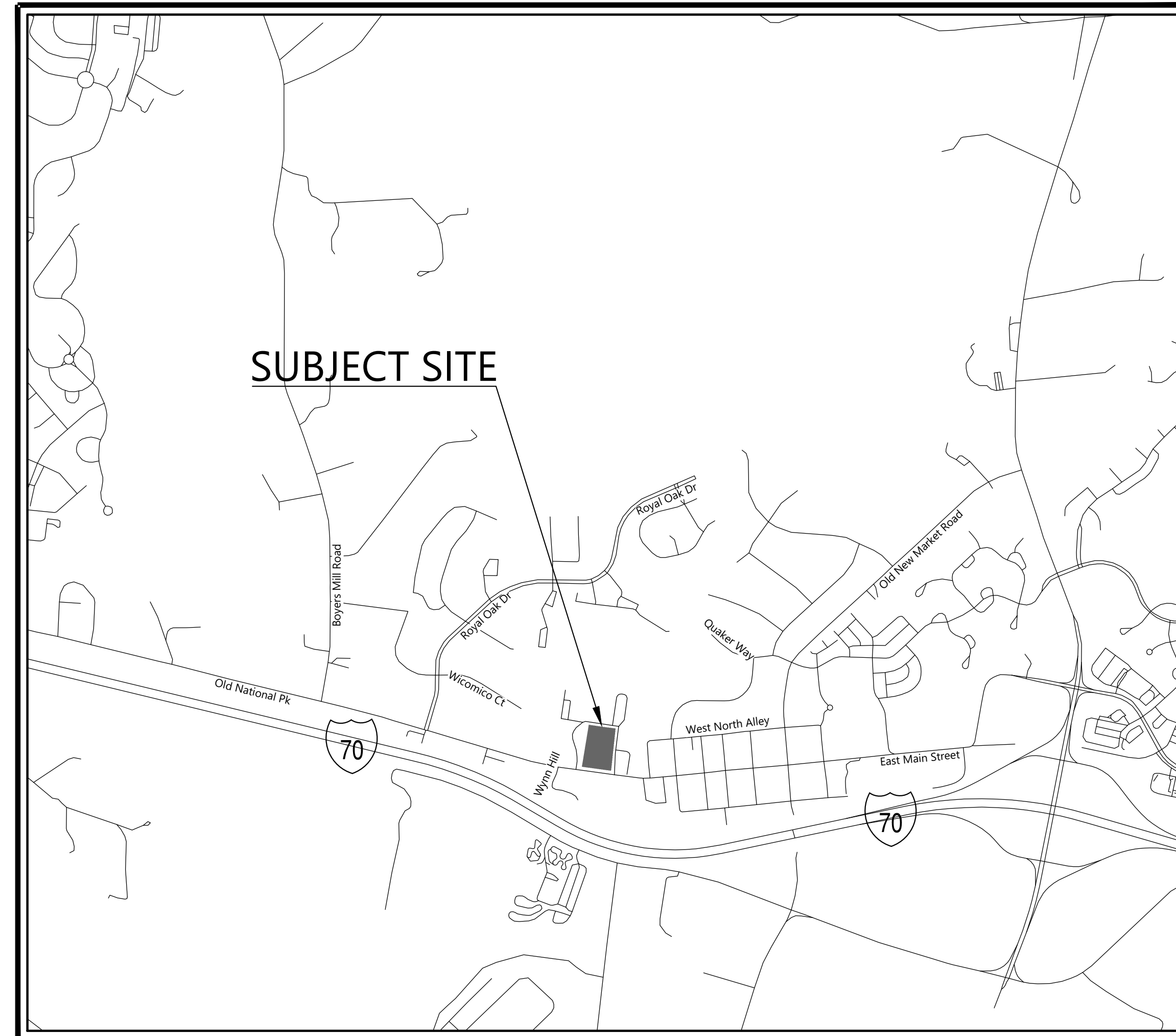

VICINITY MAP

SCALE: 1" = 1000'

FREDERICK COUNTY, MARYLAND
DEVELOPMENT REVIEW ENGINEERING

FOR STORMWATER MANAGEMENT REVIEW ONLY. REVIEWED IN ACCORDANCE WITH LOCAL COUNTY REQUIREMENTS FOR STORMWATER MANAGEMENT AND EROSION AND SEDIMENT CONTROL. FREDERICK COUNTY ASSUMES NO LIABILITY FOR DESIGN AND/OR CONSTRUCTION. APPROVAL IS VALID FOR TWO (2) YEARS AFTER THE LAST DATE SHOWN ABOVE. THE PROJECT MUST BE UNDER CONSTRUCTION BEFORE THE APPROVAL EXPIRATION TO BE CONSIDERED ACTIVE. OTHERWISE, RESUBMITTAL OF PLANS, INCLUDING APPLICABLE FEES, MUST BE MADE TO DEVELOPMENT REVIEW FOR REAPPROVAL. FEES FOR RESUBMITTAL CANNOT BE WAIVED.

REV. #	DATE	REVISION / DESCRIPTION FILL IN THESE BLOCKS FOR REVISIONS ONLY	CONSULTANT: DATE AND INITIAL	DEV. REVIEW: DATE AND INITIAL

File #:
A/P #: SP 257755
Due Date:

APPROVED BY THE TOWN OF NEW MARKET

BY: _____ DATE: _____

TAX MAP #	0801
CONCEPT SWM PLAN #	
WATER & SEWER PRELIMINARY PLAN #	
WATER & SEWER IMPROVEMENT PLAN #	
FOREST CONSERVATION PLAN #	
WATER & SEWER CONT.	

Z:\Shared\0070-00-00-105113 W Main\CAD\SWM Development Plan\01 Cover Sheet.dwg (Cover Sheet)

REVISION	DATE	REVISION	DATE
REV. TO ADDRESS COMMENTS DATE	03/01/21	03/12/21	

OWNER/DEVELOPER
WEST MAIN STREET PROPERTIES
JABEZ PROPERTIES LLC

2941 GREEN VALLEY ROAD
IJAMSVILLE, MD 21754
301-748-6148
TONY CHMELIK

COVER SHEET
DEVELOPMENT SWM PLAN



47 E South Street, Suite 302 | Frederick, MD 21701 | Office: 240-578-4010 | cbm-consulting.com

BY	DATE
BASE DATA	12/11/18
DESIGNED	JS 03/30/20
DRAWN	WK/VM 03/30/20
REVIEWED	RM 03/30/20
CONTACT:	
RELEASE FOR	<input type="checkbox"/>
BY: _____ DATE: _____	

105 WEST MAIN ST & LAWSON

TAX I.D. 09-264361 & 09-257004
TOWN OF NEW MARKET
FREDERICK COUNTY, MD

SCALE:	AS SHOWN
JOB No.	0070-00-00
DATE:	06/01/20
	CS-1
SHEET No.	1 OF 6