

EXISTING SITE
PROPERTY AREA = 119,408 SF

EXISTING IMPERVIOUS AREA	
ON-SITE	47,119 SF
TOTAL	47,119 SF

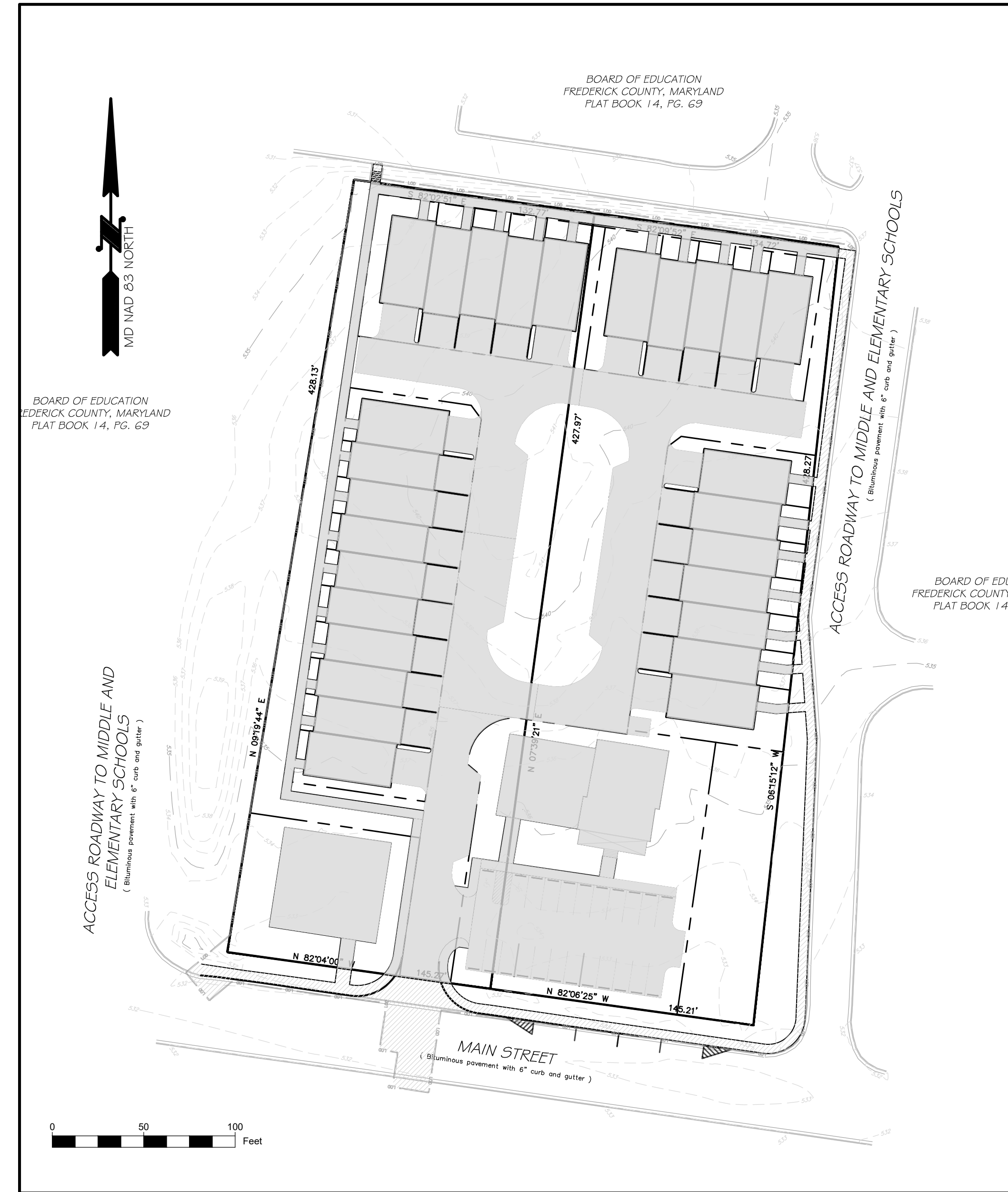

PROPOSED SITE
LOD AREA = 132,181 SF

PROPOSED IMPERVIOUS AREA (WITHIN LOD)	
ON-SITE IMP.	77,231 SF
OFF-SITE IMP.	5,961 SF
TOTAL IMP. (WITHIN LOD)	83,192 SF

FREDERICK COUNTY, MARYLAND
DEVELOPMENT REVIEW ENGINEERING

FOR STORMWATER MANAGEMENT REVIEW ONLY. REVIEWED IN ACCORDANCE WITH LOCAL COUNTY REQUIREMENTS FOR STORMWATER MANAGEMENT AND EROSION AND SEDIMENT CONTROL. FREDERICK COUNTY ASSUMES NO LIABILITY FOR DESIGN AND/OR CONSTRUCTION. APPROVAL IS VALID FOR TWO (2) YEARS AFTER THE LAST DATE SHOWN ABOVE. THE PROJECT MUST BE UNDER CONSTRUCTION BEFORE THE APPROVAL EXPIRATION TO BE CONSIDERED ACTIVE. OTHERWISE, RESUBMITTAL OF PLANS, INCLUDING APPLICABLE FEES, MUST BE MADE TO DEVELOPMENT REVIEW FOR REAPPROVAL. FEES FOR RESUBMITTAL CANNOT BE WAIVED.

REV. #	DATE	REVISION / DESCRIPTION FILL IN THESE BLOCKS FOR REVISIONS ONLY	CONSULTANT: DATE AND INITIAL	DEV. REVIEW: DATE AND INITIAL

Z:\Shared\0070-00-00 - 105113 W Main\CAD\SWM Development Plan\04 Impervious Area Map.dwg (Impervious Area Map)

REVISION	DATE	REVISION	DATE
REV. TO ADDRESS COMMENTS DATE	03/01/21	03/12/21	

OWNER/DEVELOPER
WEST MAIN STREET PROPERTIES
JABEZ PROPERTIES LLC

2941 GREEN VALLEY ROAD
IJAMSVILLE, MD 21754
301-748-6148
TONY CHMELIK

IMPERVIOUS AREA MAP
DEVELOPMENT SWM PLAN

47 E South Street, Suite 302 | Frederick, MD 21701 | Office: 240-578-4010 | cdm-consulting.com

BY	DATE
BASE DATA	12/11/18
DESIGNED	JS 03/30/20
DRAWN	WK/VM 03/30/20
REVIEWED	RM 03/30/20
CONTACT:	
RELEASE FOR	
BY	DATE

105 WEST MAIN ST & LAWSON

TAX I.D. 09-264361 & 09-257004
TOWN OF NEW MARKET
FREDERICK COUNTY, MD

SCALE: 1"=50'

JOB No. 0070-00-00

DATE: 06/01/20

IM-1

SHEET No. 4 OF 6