

PROPOSED STREET LIGHTING DETAIL ON PROPERTY

BOARD OF EDUCATION
FREDERICK COUNTY, MARYLAND
PLAT BOOK 14, PG. 69

HADC0 Urban Hagerstown

HADC0 Hagerstown LED Post Top provides the ability to create uniform light through the modern post top design to blend into any residential and historic street setting. With the latest LED technology you can maximize energy efficiency and reduce maintenance. The Hagerstown HADC0 provides excellent performance and long life of operation. The Hagerstown HADC0 provides excellent performance and long life of operation. The Hagerstown HADC0 provides excellent performance and long life of operation.

Lighting Schedule:
 Pole: P1566-12ATD (12') and P1566-10ATD (10')

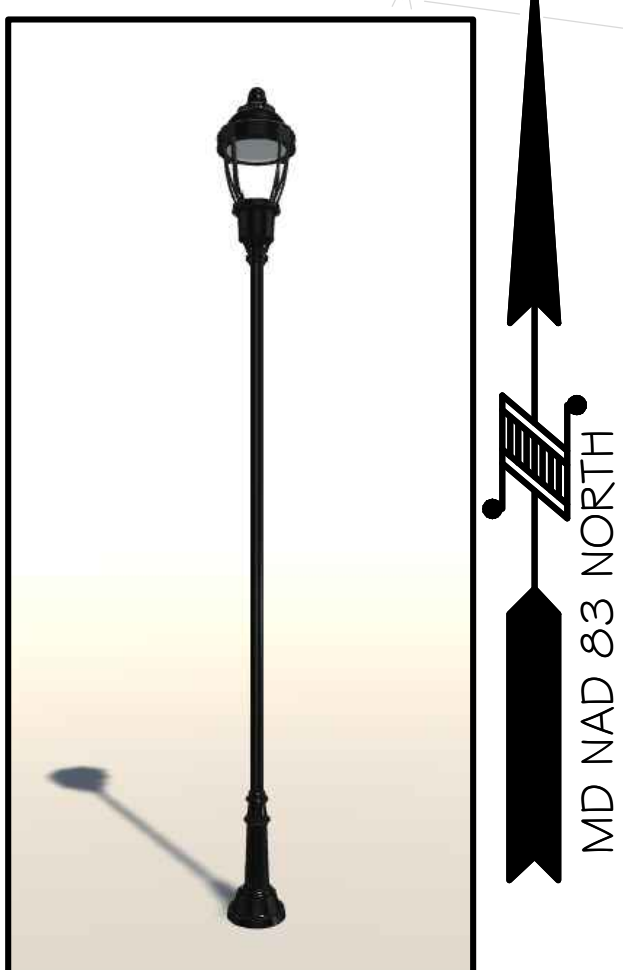

BOARD OF EDUCATION
FREDERICK COUNTY, MARYLAND
PLAT BOOK 14, PG. 69

HADC0 Urban Hagerstown

HADC0 Hagerstown LED Post Top provides the ability to create uniform light through the modern post top design to blend into any residential and historic street setting. With the latest LED technology you can maximize energy efficiency and reduce maintenance. The Hagerstown HADC0 provides excellent performance and long life of operation. The Hagerstown HADC0 provides excellent performance and long life of operation. The Hagerstown HADC0 provides excellent performance and long life of operation.

Lighting Schedule:
 Pole: P1566-12ATD (12') and P1566-10ATD (10')

HADC0 HAGERSTOWN STYLE:
10' & 12' MOUNTING HEIGHT PER TOWN SPECIFICATIONS -
Hagerstown LED Post Top, Comfort Optics, 140LED, 450mA, 32W, Type 3,
3000K Luminaire: TX03C-140-G1-H-C-HQ-N-1-A-3-N-730-A-11-N-SP1
Pole: P1566-12ATD (12') and P1566-10ATD (10')

SHIELD AS NECESSARY.
FINAL LIGHT FIXTURE QUANTITIES / LOCATIONS MAY
BE ADJUSTED TO ENSURE UNIFORM LIGHT COVERAGE WITH
NO GLARE OR SPILLOVER ONTO ADJACENT PROPERTIES.

LIGHTING SCHEDULE

QTY	ID	TYPE
10	LIGHT A	12' POLE HADC0 HAGERSTOWN
2	LIGHT B	10' POLE HADC0 HAGERSTOWN Per the Town of New Market LDO, 8.3.b, Design Factor for Luminaire Height, shall be mounted at a height equal to or less than the value 3 + (D/3), where D is the distance in feet to the nearest property boundary, 21 / 3 + 3 = 10

EXISTING LIGHTING

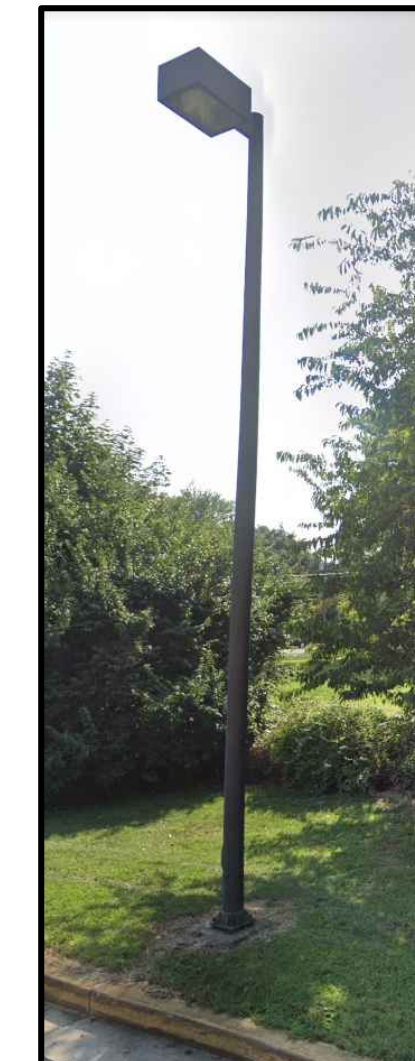

NEW MARKET COLONIAL STYLE STANDARD: LP-01A
12' MOUNTING HEIGHT PER TOWN SPECIFICATIONS -
1-70 W METAL HALIDE 8" GLASS TYPE III, VERDE BRONZE

EXISTING LIGHTS

EXISTING LIGHT LOCATIONS FROM A SURVEY BY GARY CASTLE AND ASSOCIATES DATED JULY 2018. EXISTING LIGHTING IS GENERATED BY BEST AVAILABLE INFORMATION AS PROVIDED BY FCPS AND THE TOWN OF NEW MARKET.

- NEW MARKET STANDARD - MAIN STREET - PHOTOMETRIC TEMPLATE IS BASED OFF OF A 70W AND ASSUMED 6500 LUMEN TEMPLATE. ACTUAL ISOMETRIC LINES MAY VARY BY SHA MANUFACTURER AND ARE USED FOR THE PURPOSES OF THIS STUDY TO SHOW LIGHT EFFECTS ON THE PROPERTY. ANY REFINEMENTS WILL BE REFLECTED IN THE IMPROVEMENT PLAN SET.
- EXISTING SCHOOL LIGHTING - ASSUMED LED STREETLIGHT, C SERIES, SINGLE MODULE, TYPE II MEDIUM, 4000K CCT, 100W. ACTUAL ISOMETRIC LINES MAY VARY BY MANUFACTURER AND ARE USED FOR THE PURPOSES OF THIS STUDY TO SHOW LIGHT EFFECTS ON THE PROPERTY. ANY REFINEMENTS WILL BE REFLECTED IN THE IMPROVEMENT PLAN SET.

ACCESS ROADWAY TO MIDDLE AND
ELEMENTARY SCHOOLS
(Bituminous pavement with 6" curb and gutter)

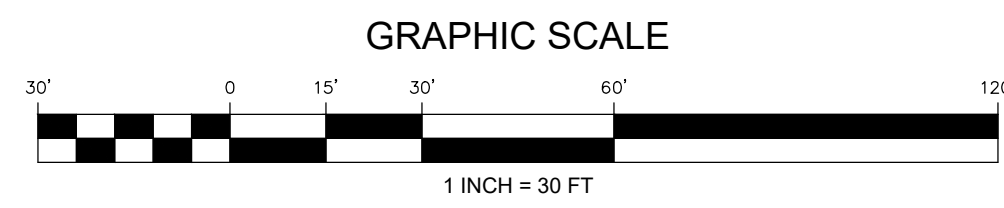
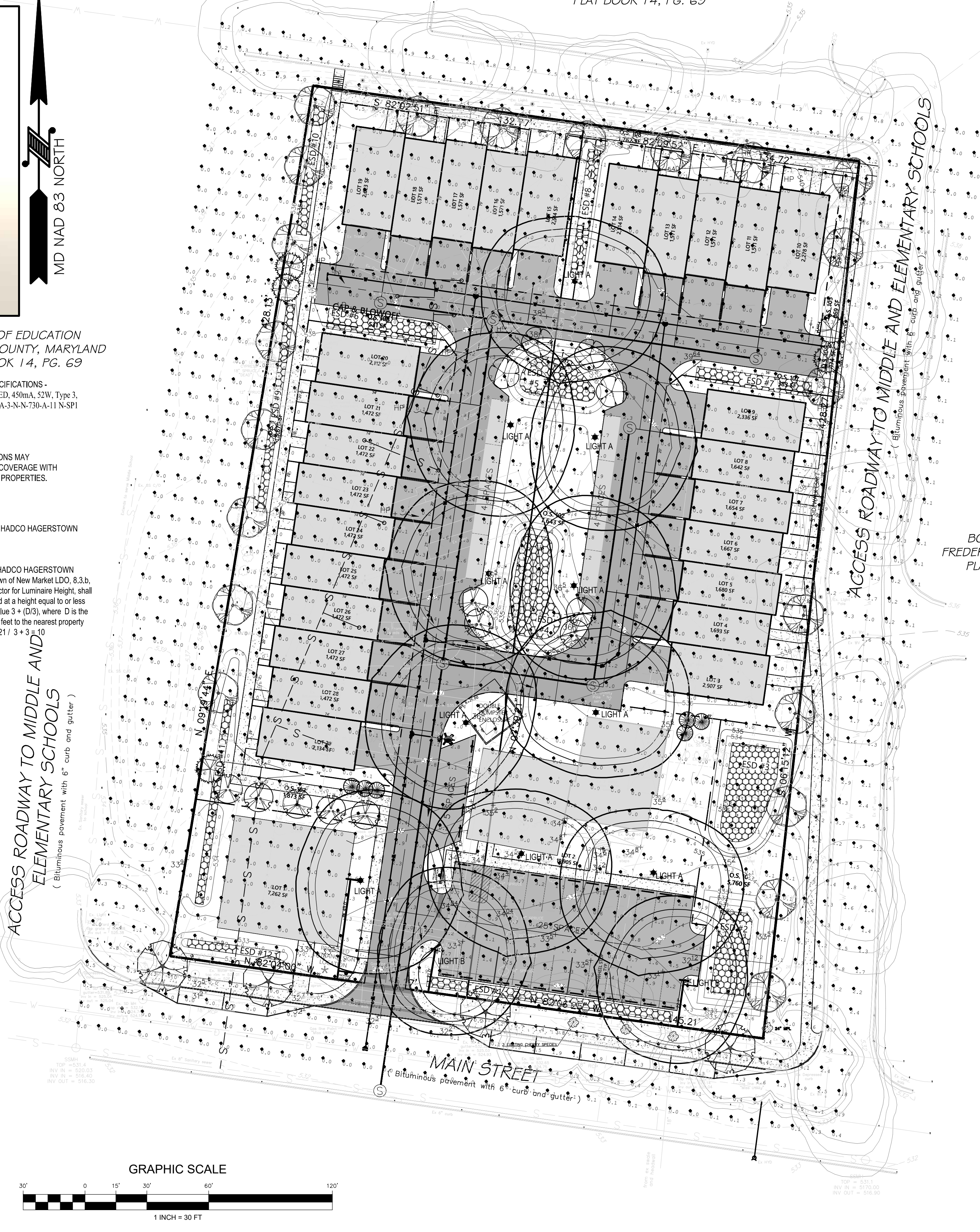

GENERAL NOTATIONS

- Plan shall conform to Article V, Section 8.3 "Outdoor Lighting" of the LDO. Photometrics and final lighting locations will be provided at time of improvement Plan submission.
- Lighting will be reviewed and approved by HDC prior to issuance of Building permit.
- Town of New Market LDO Article V, Section 3.2.3 (c)(2) Medium and large trees (taller than 25 feet at maturity) - 1 per 40 linear feet of street frontage or open space.
Linear Frontage along Main St = 290.47 LF
290.47 / 40 = 7.26 or 8 Street Trees Required
Provided: 8 Street Trees (4 new proposed, 4 existing)
- Storm water management ESD facilities will be planted. Planting plan and details will be provided at time of Improvement Plans.

PLANTING COST ESTIMATE CHART

PLANT TYPE	COST PER UNIT*	NUMBER OF UNITS	TOTAL COST
DECIDUOUS TREE	\$400.00	34	\$13,600.00
FLOWERING TREE	\$200.00	4	\$800.00
EVERGREEN TREE	\$400.00	11	\$4,400.00
TOTAL			\$18,800.00

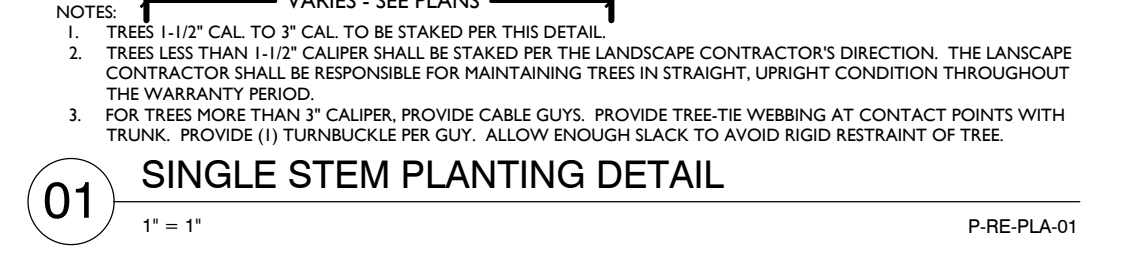
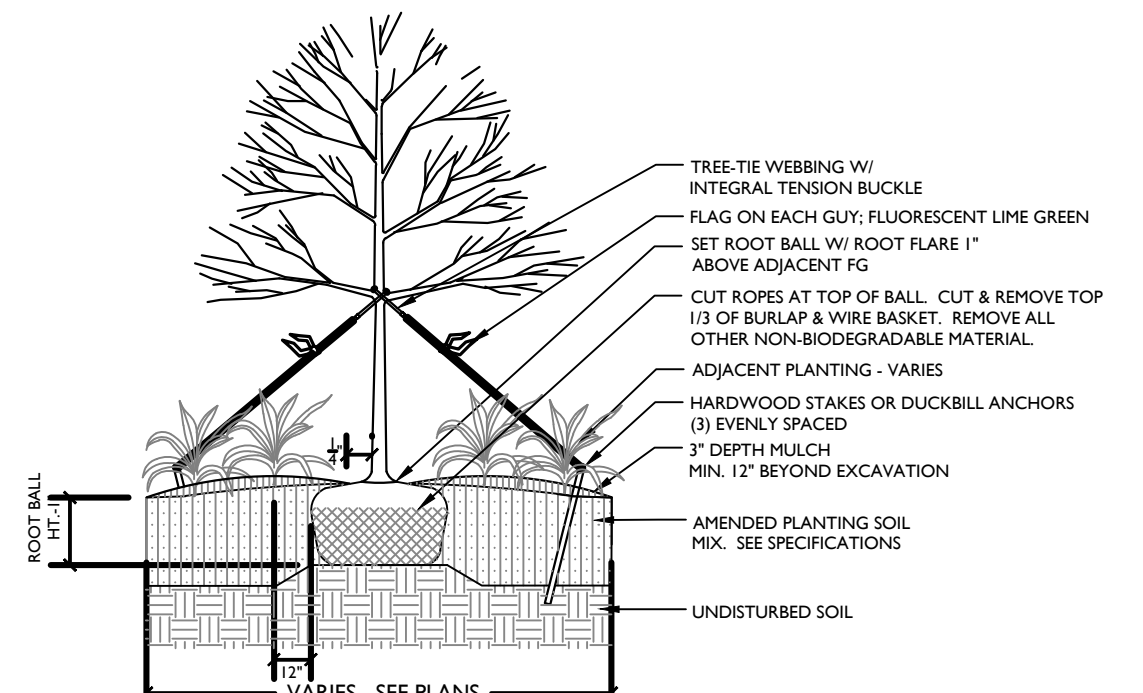

PLANT SCHEDULE

DECIDUOUS TREES	QTY	BOTANICAL NAME	COMMON NAME	SIZE	CONTAINER
	9	Betula nigra 'Heritage'	Heritage River Birch	2" Cal.	B&B
	4	Quercus phellos	Willow Oak	2" Cal.	B&B
	21	Ulmus parvifolia 'Emer II' TM	Allee Elm	2" Cal.	B&B
EVERGREEN TREES	QTY	BOTANICAL NAME	COMMON NAME	SIZE	CONTAINER
	5	Cedrus deodara	Deodar Cedar	7' - 8' Ht.	B&B
	6	Picea pungens	Colorado Spruce	5' - 6' Ht.	B&B
FLOWERING TREES	QTY	BOTANICAL NAME	COMMON NAME	SIZE	CONTAINER
	4	Cercis canadensis	Eastern Redbud Multi-trunk	1.5" Cal.	B&B

Existing Street Tree

ESD PLANTING AREAS

ESD Facilities to be planted; detailed planting plans to be provided at time of Site Plan/Improvement plan.

Z:\Shared\0070-00-00 - 105113 W Main\CAD\Preliminary Plan\Sht 006 - Landscape Plan.dwg (sht 6 landscape plan)

REVISION	DATE	REVISION	DATE
REV. TO ADDRESS COMMENTS DATE 10/23/20	12/09/20		
REV. TO ADDRESS DUSWM 2/1/21 COMMENTS	03/01/21		
REV. TO ADDRESS 6/2/21 STAFF COMMENTS, COUNTS, ADD LIGHTING, SCREENING	06/15/21		

OWNER/DEVELOPER
WEST MAIN STREET PROPERTIES
JABEZ PROPERTIES LLC

2941 GREEN VALLEY ROAD
IJAMSVILLE, MD 21754
301-748-6146
TONY CHMELIK

**LANDSCAPE AND LIGHTING
PRELIMINARY PLAT**

47 E South Street, Suite 302 | Frederick, MD 21701 | Office: 240-578-0010 | cdm-consulting.com

BY	DATE
BASE DATA	12/11/18
DESIGNED	DC/BM 03/30/20
DRAWN	WK/VM 03/30/20
REVIEWED	RM 03/30/20

CONTACT: _____

RELEASE FOR

BY: _____ DATE: _____

105 WEST MAIN ST & LAWSON PROPERTIES

TAX I.D. 09-264361 & 09-257004
TOWN OF NEW MARKET
FREDERICK COUNTY, MD

SCALE: 1" = 30'
JOB No. 0070-00-00
DATE: 07/14/20
SHEET No. 6 OF 8